

# **GOLDEN WINCH**



**ZHEJIANG JINHUA RUNVA  
MACHINERY & ELECTRIC MANUFACTURING CO.,LTD**

# **GOLDEN WINCH**

ZHEJIANG JINHUA RUNVA  
MACHINERY & ELECTRIC MANUFACTURING CO.,LTD.

Intro



duction

# WELCOME

## Introduction

Jinhua Runva Machinery&Electric Manufacturing Co.,Ltd founded in 1997 with an area over 36,000 square meters. We are the pioneer professional manufacturer of electric winches with establishment of professional R&D center in China mainland.Our advanced technology enables us to design&develop and produce all kinds of winches. Under ISO9001:2000 quality control system, our high quality winches are sold to America,Australia,West Europe,South-east Asia,South Africa and so on, and being popular to people.

We have ranges of winch including hand,electric and hydraulic winches,of which have dozens of specifications.The products have their own unique design,steady capability,security and reliability. The main function of winch is the vehicle automatically rescue in bad road conditions(such as in desert,forest,Gobi,wetland,hilly country,etc) or pull heavy objectives indoor and outdoor.It have been widely used in the recovery, recreational, commercial,military and engineering, etc.

Throughout the years,we have put great efforts on advanced technology,diligence,dedulity to keep our company constantly growth in term of trust, technology and service. We award the top-rank level and get the credit of hundred professional experts by endeavouring to improve our ability and skill, we will always stick to research,renovate and develop,constantly strive to become stronger,our vision is to be one of the top-rank winch manufacturers with high quality products.



**CONTENT****• EW Series Electric Winches**

|                                |    |
|--------------------------------|----|
| KEW2000 Series Electric Winch  | 1  |
| KEW3000 Series Electric Winch  | 2  |
| EWP2500 Series Electric Winch  | 3  |
| EWP3500 Series Electric Winch  | 4  |
| KEW4000 Series Electric Winch  | 5  |
| KEW4500 Series Electric Winch  | 5  |
| KEW5000 Series Electric Winch  | 6  |
| KEW8000 Series Electric Winch  | 7  |
| GEW6000 Series Electric Winch  | 8  |
| GEW8000 Series Electric Winch  | 9  |
| GEW9000 Series Electric Winch  | 10 |
| GEW10000 Series Electric Winch | 11 |
| EWX9500 Series Electric Winch  | 12 |
| NEW10000 Series Electric Winch | 13 |
| NEW12000 Series Electric Winch | 13 |
| NEW15000 Series Electric Winch | 14 |

**• EW Series Two Speed Electric Winches**

|                                   |    |
|-----------------------------------|----|
| BEW12000 Two Speed Electric Winch | 14 |
|-----------------------------------|----|

**• HW Series Hydraulic Winches**

|   |    |
|---|----|
| NHW10000 Electric Valve Control Hydraulic Winch | 15 |
| NHW12000 Electric Valve Control Hydraulic Winch | 15 |
| NHW15000 Electric Valve Control Hydraulic Winch | 16 |

**• HW Series Two Speed Hydraulic Winches**

|                                    |    |
|------------------------------------|----|
| BHW10000 Two Speed Hydraulic Winch | 16 |
| BHW12000 Two Speed Hydraulic Winch | 17 |
| BHW15000 Two Speed Hydraulic Winch | 17 |

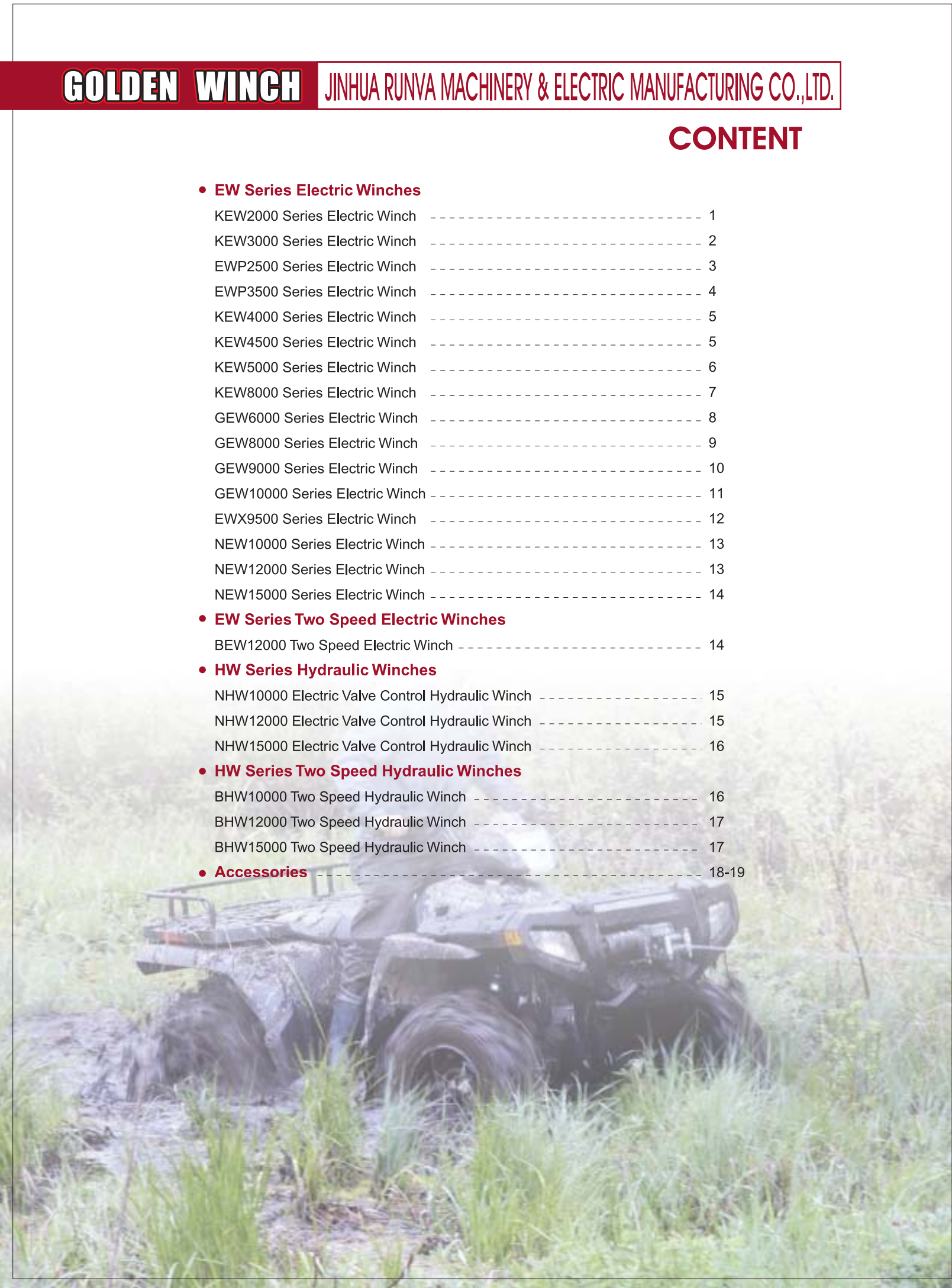
**• Accessories** 18-19

# GOLDEN WINCH EW2000 SERIES

## KEW2000



### Specification:

|                        |                                      |
|------------------------|--------------------------------------|
| Rated line pull        | 2000lbs(907kgs)                      |
| Motor:permanent magnet | 1.08kW/1.5hp(12V); 1.32kW/1.8hp(24V) |
| Gear reduction ratio   | 153:1                                |
| Cable(Dia. ϕL)         | ϕ5/32" ϕ1.24" (ϕ4mm ϕ15mm)           |
| Drum size(Dia. ϕL)     | ϕ1.24" ϕ2.88" (ϕ31.5mm ϕ73mm)        |
| Mounting bolt pattern  | 3.13"(79.5mm)                        |

### KEW2000:

|                             |  |
|-----------------------------|--|
| Overall dimensions(L ϕW ϕH) | 11.2" ϕ4.1" ϕ4.1"(285mm ϕ105mm ϕ105mm) |
| Weight                      | 14.8lbs (6.7kgs)                       |

### KEW2000A:

|                             |  |
|-----------------------------|--|
| Overall dimensions(L ϕW ϕH) | 11.2" ϕ4.1" ϕ5.9"(285mm ϕ105mm ϕ150mm) |
| Weight                      | 15lbs (6.8kgs)                         |

## KEW2000A

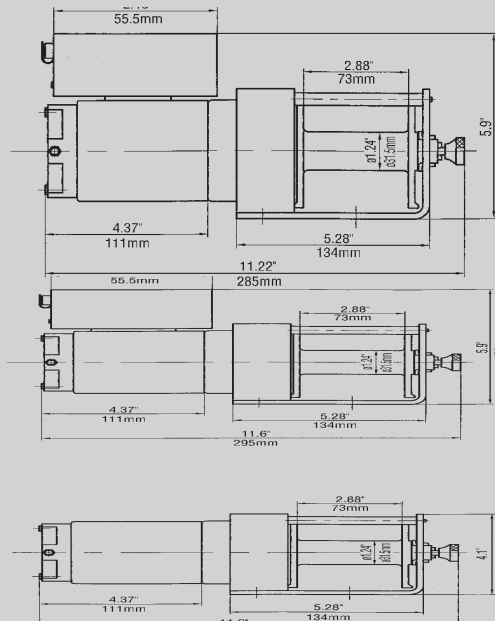

### Features:

- 1) Free spooling clutch
- 2) Automatic braking action
- 3) Rated line pull with snatch block
- 4) SWR tensioner
- 5) DC 12V or DC 24V power drive
- 6) A snatch block supplied as a standard accessory
- 7) High current working switch control directly
- 8) ATV Handlebar switch control

### Pull, Speed, Amperes, Volts(First layer)

| Line Pull | Line Speed |           | Current |        |
|-----------|------------|-----------|---------|--------|
|           | ft/min     | m/min     | A       |        |
| lbs (kgs) | 12V DC     | 24V DC    | 12V DC  | 24V DC |
| 0         | 10.5(3.2)  | 11.8(3.6) | 12      | 6      |
| 500(227)  | 9.2(2.8)   | 10.2(3.1) | 25      | 10     |
| 1000(454) | 7.5(2.3)   | 8.5(2.6)  | 40      | 15     |
| 1500(680) | 5.9(1.8)   | 6.9(2.1)  | 60      | 25     |
| 2000(907) | 3.3(1.0)   | 3.6(1.1)  | 90      | 55     |

### Line Pull And Rope Capacity In Layer

| Layer | Rated Line Pull | Total Rope On Drum |
|-------|-----------------|--------------------|
|       | lbs(kgs)        | ft (m)             |
| 1     | 2000(907)       | 6.5(2.0)           |
| 2     | 1630(739)       | 14.0(4.3)          |
| 3     | 1380(626)       | 22.0(6.8)          |
| 4     | 1190(540)       | 31.0(9.5)          |
| 5     | 1050(476)       | 41.0(12.5)         |
| 6     | 940(426)        | 49.0(15.0)         |

### Fittings and Accessories(optional):

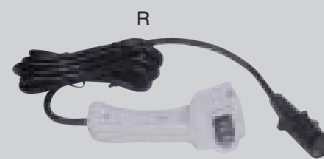

Website: [www.goldenwinch.es](http://www.goldenwinch.es)

# GOLDEN WINCH EW3000 SERIES

## KEW3000



### Specification:

|                                 |  |
|---------------------------------|--|
| Rated line pull                 | 3000lbs(1361kgs)   |
| Motor:permanent magnet          | 1.8kW/2.5hp(12V);2.4kW/3.2hp(24V)  |
| Gear reduction ratio            | 153:1  |
| Cable(Dia. $\varnothing$ L)     | $\varnothing$ 3/16" $\varnothing$ 45.9" ( $\varnothing$ 4.8mm $\varnothing$ 14m)   |
| Drum size(Dia. $\varnothing$ L) | $\varnothing$ 1.24" $\varnothing$ 2.88" ( $\varnothing$ 31.5mm $\varnothing$ 73mm) |
| Mounting bolt pattern           | 3.13"(79.5mm)  |

### KEW3000:

|   |  |
|---|--|
| Overall dimensions(L $\varnothing$ W $\varnothing$ H) | 12.6" $\varnothing$ 4.6" $\varnothing$ 4.1"(320mm $\varnothing$ 116mm $\varnothing$ 105mm) |
| Weight  | 19.1lbs(8.6kgs)  |

### KEW3000A:

|   |  |
|---|--|
| Overall dimensions(L $\varnothing$ W $\varnothing$ H) | 12.6" $\varnothing$ 4.6" $\varnothing$ 5.9"(320mm $\varnothing$ 116mm $\varnothing$ 150mm) |
| Weight  | 20.3lbs(9.19kgs)   |

## KEW3000A

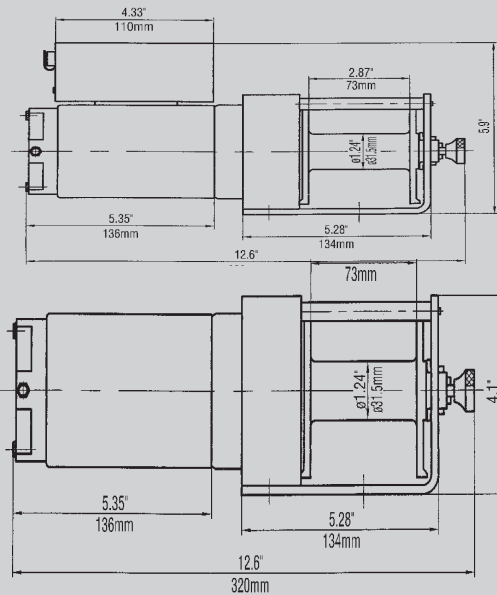

### Features:

- 1) Free spooling clutch
- 2) Automatic braking action
- 3) Full steel reducer gear
- 4) DC 12V or DC 24V power drive
- 5) A snatch block supplied as a standard accessory
- 6) High current working switch control directly
- 7) ATV Handlebar switch control
- 8) Control box detachable fixing
- 9) Remote control with control box and switch
- 10) Wireless remote control

### Pull,Speed, Amperes, Volts(First layer)

| Line Pull<br>lbs (kgs) | Line Speed<br>ft/min (m/min) |        | Current<br>A |        |
|------------------------|------------------------------|--------|--------------|--------|
|                        | 12V DC                       | 24V DC | 12V DC       | 24V DC |
| 0                      | 9.5(2.9)                     |        | 10           |        |
| 1000(454)              | 6.6(2.0)                     |        | 25           |        |
| 2000(907)              | 4.3(1.3)                     |        | 60           |        |
| 3000(1361)             | 2.3(0.7)                     |        | 150          |        |

### Line Pull And Rope Capacity In Layer

| Layer | Rated Line Pull<br>lbs(kgs) | Total Rope On Drum<br>ft (m) |
|-------|-----------------------------|------------------------------|
| 1     | 3000(1361)                  | 5.6(1.7)                     |
| 2     | 2370(1075)                  | 12.1(3.7)                    |
| 3     | 1960(889)                   | 19.7(6.0)                    |
| 4     | 1670(756)                   | 27.9(8.5)                    |
| 5     | 1460(662)                   | 37.1(11.3)                   |
| 6     | 1290(585)                   | 46.9(14.0)                   |

### Fittings and Accessories(optional):

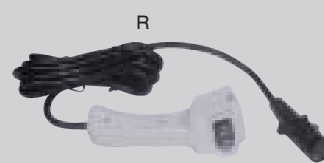

# GOLDEN WINCH EW2500 SERIES

## EWP2500



### Specification:

|                                 |  |
|---------------------------------|--|
| Rated line pull                 | 2500lbs(1134kgs)   |
| Motor:permanent magnet          | 1.8kW/2.5hp(12V); 2.4kW/3.2hp(24V)   |
| Gear reduction ratio            | 170:1  |
| Cable(Dia. $\varnothing$ L)     | $\varnothing$ 3/16" $\varnothing$ 45.9'( $\varnothing$ 4.8mm $\varnothing$ 14m)  |
| Drum size(Dia. $\varnothing$ L) | $\varnothing$ 1.46" $\varnothing$ 3.15" ( $\varnothing$ 37mm $\varnothing$ 80mm) |
| Mounting bolt pattern           | 3.13"(79.5mm)  |

### EWP2500:

|   |  |
|---|--|
| Overall dimensions(L $\varnothing$ W $\varnothing$ H) | 12.4" $\varnothing$ 4.6" $\varnothing$ 4.4"(314mm $\varnothing$ 116mm $\varnothing$ 112mm) |
| Weight  | 19.6lbs(8.89kgs)   |

### EWP2500A:

|   |   |
|---|---|
| Overall dimensions(L $\varnothing$ W $\varnothing$ H) | 12.8" $\varnothing$ 4.6" $\varnothing$ 6.49"(325mm $\varnothing$ 116mm $\varnothing$ 165mm) |
| Weight  | 20.7lbs(9.39kgs)  |

## EWP2500A

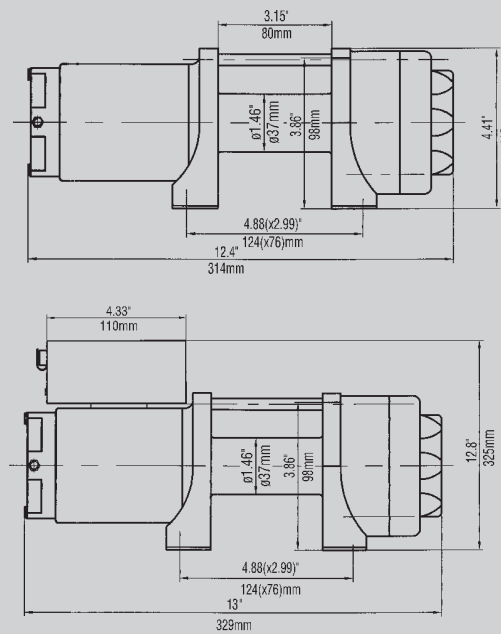

### Features:

- 1) Free spooling clutch
- 2) Automatic braking action
- 3) Full steel reducer gear
- 4) DC 12V or DC 24V power drive
- 5) A snatch block supplied as a standard accessory
- 6) High current working switch control directly
- 7) ATV Handlebar switch control
- 8) Control box detachable fixing
- 9) Remote control with control box and switch
- 10) Wireless remote control

### Pull,Speed, Amperes, Volts(First layer)

| Line Pull<br>lbs (kgs) | Line Speed<br>ft/min (m/min) |        | Current<br>A |        |
|------------------------|------------------------------|--------|--------------|--------|
|                        | 12V DC                       | 24V DC | 12V DC       | 24V DC |
| 0                      | 9.1(2.8)                     |        | 20           |        |
| 500(227)               | 7.5(2.3)                     |        | 50           |        |
| 1500(680)              | 5.9(1.8)                     |        | 100          |        |
| 2500(1134)             | 2.6(0.8)                     |        | 150          |        |

### Line Pull And Rope Capacity In Layer

| Layer | Rated Line Pull | Line speed ft/min | Total Rope On Drum |
|-------|-----------------|-------------------|--------------------|
|       | lbs(kgs)        | (m/min) No load   | ft (m)             |
| 1     | 2500(1134)      | 9.1(2.8)          | 7.15(2.18)         |
| 2     | 2033(922)       | 11.0(3.3)         | 15.45(4.71)        |
| 3     | 1713(777)       | 12.8(3.9)         | 24.7(7.52)         |
| 4     | 1480(671)       | 14.8(4.5)         | 34.5(10.52)        |
| 5     | 1303(591)       | 17.0(5.2)         | 45.9(14.0)         |

### Fittings and Accessories(optional):



Website: [www.goldenwinch.es](http://www.goldenwinch.es)

# GOLDEN WINCH EW3500 SERIES

## EWP3500



### Specification:

|                                 |  |
|---------------------------------|--|
| Rated line pull                 | 3500lbs(1588kgs)   |
| Motor:permanent magnet          | 2.76kW/3.68hp(12V); 4.32kW/5.76hp(24V)   |
| Gear reduction ratio            | 170:1  |
| Cable(Dia. $\varnothing$ L)     | $\varnothing$ 7/32" $\varnothing$ 42'( $\varnothing$ 5.4mm $\varnothing$ 12.8m)  |
| Drum size(Dia. $\varnothing$ L) | $\varnothing$ 1.46" $\varnothing$ 3.15" ( $\varnothing$ 37mm $\varnothing$ 80mm) |
| Mounting bolt pattern           | 3.13"(79.5mm)  |

### EWP3500:

|   |  |
|---|--|
| Overall dimensions(L $\varnothing$ W $\varnothing$ H) | 13" $\varnothing$ 4.6" $\varnothing$ 4.4"(329mm $\varnothing$ 116mm $\varnothing$ 112mm) |
| Weight  | 20.7lbs(9.39kgs)   |

### EWP3500A:

|   |   |
|---|---|
| Overall dimensions(L $\varnothing$ W $\varnothing$ H) | 13" $\varnothing$ 4.6" $\varnothing$ 6.49"(329mm $\varnothing$ 116mm $\varnothing$ 165mm) |
| Weight  | 21.8lbs(9.89kgs)  |

## EWP3500A

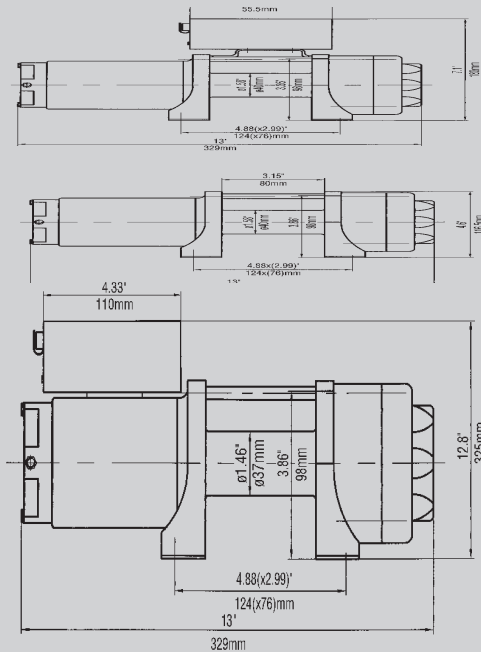

### Features:

- 1) Free spooling clutch
- 2) Automatic braking action
- 3) Full steel reducer gear
- 4) DC 12V or DC 24V power drive
- 5) A snatch block supplied as a standard accessory
- 6) High current working switch control directly
- 7) ATV Handlebar switch control
- 8) Control box detachable fixing
- 9) Remote control with control box and switch
- 10) Wireless remote control

### Pull,Speed, Amperes, Volts(First layer)

| Line Pull<br>lbs (kgs) | Line Speed<br>ft/min (m/min) |        | Current<br>A |        |
|------------------------|------------------------------|--------|--------------|--------|
|                        | 12V DC                       | 24V DC | 12V DC       | 24V DC |
| 0                      | 8.2(2.5)                     |        | 20           |        |
| 1000(454)              | 6.6(2.0)                     |        | 50           |        |
| 2000(907)              | 4.6(1.4)                     |        | 100          |        |
| 3500(1588)             | 2.3(0.7)                     |        | 160          |        |

### Line Pull And Rope Capacity In Layer

| Layer | Rated Line Pull<br>lbs(kgs) | Line speed ft/min<br>(m/min) No load | Total Rope On Drum<br>ft (m) |
|-------|-----------------------------|--------------------------------------|------------------------------|
| 1     | 3500(1588)                  | 8.2(2.5)                             | 6.23(1.9)                    |
| 2     | 2790(1266)                  | 10.1(3.1)                            | 13.8(4.2)                    |
| 3     | 2320(1052)                  | 12.5(3.8)                            | 22.3(6.8)                    |
| 4     | 1984(900)                   | 14.4(4.4)                            | 31.8(9.7)                    |
| 5     | 1733(786)                   | 16.7(5.1)                            | 42(12.8)                     |

### Fittings and Accessories(optional):



# GOLDEN WINCH EW4000/4500 SERIES

**KEW4000**



**KEW4500**



**Specification:**

| Item                               | KEW4000                                 | KEW4500                                 |
|------------------------------------|---|---|
| Rated line pull                    | 4000lbs(1814kgs)                        | 4500lbs(2041kgs)                        |
| Motor:permanent magnet             | 1.8kW/2.5hp(12V); 2.4kW/3.2hp(24V)      | 2.76kW/3.68hp(12V); 4.32kW/5.76hp(24V)  |
| Gear reduction ratio               | 423:1                                   | 423:1                                   |
| Cable(Dia. 直径)                     | 1/2" 1.8" (12.7mm 45.7mm)               | 1/2" 1.8" (12.7mm 45.7mm)               |
| Drum size(Dia. 直径)                 | 1.8" 3.78" (45.7mm 96mm)                | 1.8" 3.78" (45.7mm 96mm)                |
| Mounting bolt pattern              | 3.68"(93.5mm)or4.3" 109mm (109mm 106mm) | 3.68"(93.5mm)or5.1" 129mm (129mm 106mm) |
| Overall dimensions(L 长度 W 宽度 H 高度) | 12.7" 5.6" 6.3" (323mm 142mm 160mm)     | 13.5" 5.6" 6.3" (343mm 142mm 160mm)     |
| Weight                             | 27.6lbs(12.5kgs)                        | 30.0lbs(13.6kgs)                        |

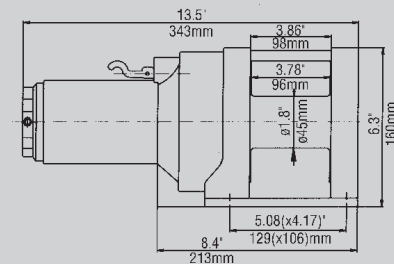
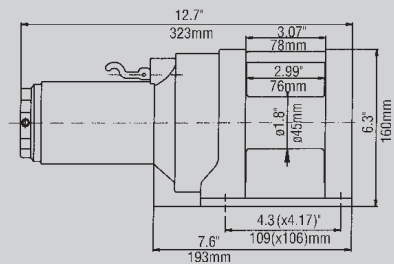

**Pull,Speed, Amperes, Volts(First layer)**

| Line Pull<br>lbs (kgs) | Line Speed<br>ft/min (m/min) |          | Current<br>A |        |
|------------------------|------------------------------|----------|--------------|--------|
|                        | 12V DC                       | 24V DC   | 12V DC       | 24V DC |
| 0                      | 7.0(2.1)                     | 7.5(2.3) | 30           | 20     |
| 1000(454)              | 6.0(1.9)                     | 6.6(2.0) | 50           | 30     |
| 2000(907)              | 5.6(1.7)                     | 6.0(1.8) | 70           | 45     |
| 3000(1361)             | 5.3(1.6)                     | 5.0(1.5) | 100          | 75     |
| 4000(1814)             | 5.0(1.5)                     | 4.6(1.4) | 150          | 100    |

**Line Pull And Rope Capacity In Layer**

| Layer | Rated Line Pull<br>lbs(kgs) | Total Rope On Drum<br>ft (m) |
|-------|-----------------------------|------------------------------|
| 1     | 4000(1814)                  | 7.2(2.2)                     |
| 2     | 3300(1497)                  | 15.5(4.7)                    |
| 3     | 2800(1270)                  | 24.6(7.5)                    |
| 4     | 2400(1089)                  | 34.5(10.5)                   |
| 5     | 2200(998)                   | 44.2(13.5)                   |
| 6     | /                           | 52.5(16.0)                   |

**Pull,Speed, Amperes, Volts(First layer)**

| Line Pull<br>lbs (kgs) | Line Speed<br>ft/min (m/min) |          | Current<br>A |        |
|------------------------|------------------------------|----------|--------------|--------|
|                        | 12V DC                       | 24V DC   | 12V DC       | 24V DC |
| 0                      | 7.0(2.1)                     | 7.5(2.3) | 30           | 20     |
| 1000(454)              | 6.0(1.9)                     | 6.6(2.0) | 50           | 30     |
| 2000(907)              | 5.6(1.7)                     | 6.0(1.8) | 70           | 45     |
| 3000(1361)             | 5.3(1.6)                     | 5.0(1.5) | 100          | 75     |
| 4500(2041)             | 4.6(1.3)                     | 4.0(1.1) | 180          | 120    |

**Line Pull And Rope Capacity In Layer**

| Layer | Rated Line Pull<br>lbs(kgs) | Total Rope On Drum<br>ft (m) |
|-------|-----------------------------|------------------------------|
| 1     | 4500(2041)                  | 7.8(2.5)                     |
| 2     | 3650(1656)                  | 17.0(5.5)                    |
| 3     | 3080(1397)                  | 28.0(8.9)                    |
| 4     | 2660(1207)                  | 41.0(12.5)                   |
| 5     | 2340(1061)                  | 52.5(16.0)                   |
| 6     | /                           | 59.0(18.0)                   |

**Features:**

- 1) Free spooling clutch
- 2) Automatic braking action
- 3) Rated line pull by using snatch block
- 4) Specially designed differential gearing for heavy duty
- 5) Specially designed shape for convenient installation and good looking
- 6) Remote control with control box and switch
- 7) Wireless remote control
- 8) DC 12V or DC 24V power drive

**Fittings and Accessories(optional):**



Website: [www.goldenwinch.es](http://www.goldenwinch.es)

# GOLDEN WINCH EW5000 SERIES

## KEW5000



### Specification:

|                                 |  |
|---------------------------------|--|
| Rated line pull                 | 5000lbs(2268kgs)   |
| Motor:permanent magnet          | 2.76kW/3.68hp(12V); 4.32kW/5.76hp(24V)   |
| Gear reduction ratio            | 294:1(12V);210:1(24V)  |
| Cable(Dia. $\varnothing$ L)     | $\varnothing$ 1/4" $\varnothing$ 79' ( $\varnothing$ 6mm $\varnothing$ 24m)      |
| Drum size(Dia. $\varnothing$ L) | $\varnothing$ 2.48" $\varnothing$ 5.5" ( $\varnothing$ 63mm $\varnothing$ 140mm) |
| Mounting bolt pattern           | 6.55" $\varnothing$ 4.5" (166.4mm $\varnothing$ 114.3mm)                         |

### KEW5000:

|   |   |
|---|---|
| Overall dimensions(L $\varnothing$ W $\varnothing$ H) | 17.3" $\varnothing$ 7.1" $\varnothing$ 6.8" (440mm $\varnothing$ 180mm $\varnothing$ 173mm) |
| Weight  | 47.4lbs(21.5kgs)  |

### KEW5000-S:

|   |   |
|---|---|
| Overall dimensions(L $\varnothing$ W $\varnothing$ H) | 17.3" $\varnothing$ 7.1" $\varnothing$ 10.63" (440mm $\varnothing$ 180mm $\varnothing$ 270mm) |
| Weight  | 49.8lbs(22.6kgs)  |

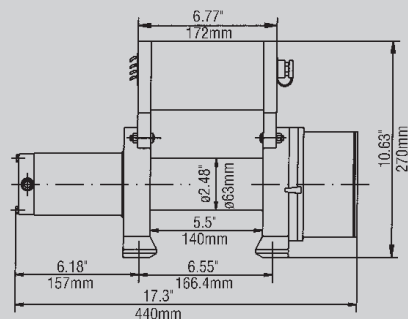
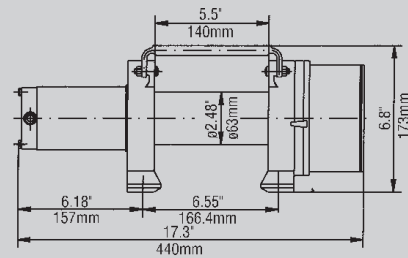

## KEW5000-S



### Features:

- 1) Free spooling clutch
- 2) Automatic braking action
- 3) DC 12V or DC 24V power drive
- 4) Remote control with control box and switch
- 5) Wireless remote control

### Pull,Speed, Amperes, Volts(First layer)

| Line Pull  | Line Speed |           | Current |        |
|------------|------------|-----------|---------|--------|
|            | ft/min     | m/min     | 12V DC  | 24V DC |
| 0          | 12.0(3.7)  | 18.0(5.5) | 45      | 25     |
| 1000(454)  | 10.0(3.2)  | 16.0(4.8) | 90      | 55     |
| 3000(1361) | 7.5(2.3)   | 11.5(3.5) | 150     | 110    |
| 5000(2268) | 5.0(1.5)   | 5.3(1.6)  | 230     | 180    |

### Line Pull And Rope Capacity In Layer

| Layer | Rated Line Pull | Total Rope On Drum |
|-------|-----------------|--------------------|
|       | lbs(kgs)        | ft (m)             |
| 1     | 5000(2268)      | 14.7(4.5)          |
| 2     | 4200(1905)      | 29.5(9.0)          |
| 3     | 3700(1678)      | 56.0(17.0)         |
| 4     | 3200(1452)      | 79.0(24.0)         |

### Fittings and Accessories(optional):



# GOLDEN WINCH EW8000 SERIES

## KEW8000



### Specification:

|                                 |  |
|---------------------------------|--|
| Rated line pull                 | 8000lbs(3629kgs)   |
| Motor:permanent magnet          | 4.2kW/5.6hp(12V); 5.76kW/7.68hp(24V)   |
| Gear reduction ratio            | 210:1(12V);150:1(24V)  |
| Cable(Dia. $\varnothing$ L)     | $\varnothing$ 5/16" $\varnothing$ 95' ( $\varnothing$ 8mm $\varnothing$ 29m)   |
| Drum size(Dia. $\varnothing$ L) | $\varnothing$ 2.48" $\varnothing$ 9" ( $\varnothing$ 63mm $\varnothing$ 228mm) |
| Mounting bolt pattern           | 10" $\varnothing$ 4.5" (254mm $\varnothing$ 114.3mm)                           |

### KEW8000:

|   |   |
|---|---|
| Overall dimensions(L $\varnothing$ W $\varnothing$ H) | 20.9" $\varnothing$ 7.1" $\varnothing$ 6.8" (530mm $\varnothing$ 180mm $\varnothing$ 173mm) |
| Weight  | 65.5lbs(29.7kgs)  |

### KEW8000-S:

|   |   |
|---|---|
| Overall dimensions(L $\varnothing$ W $\varnothing$ H) | 20.9" $\varnothing$ 7.1" $\varnothing$ 10.63" (530mm $\varnothing$ 180mm $\varnothing$ 270mm) |
| Weight  | 68.1lbs(30.9kgs)  |

## KEW8000-S

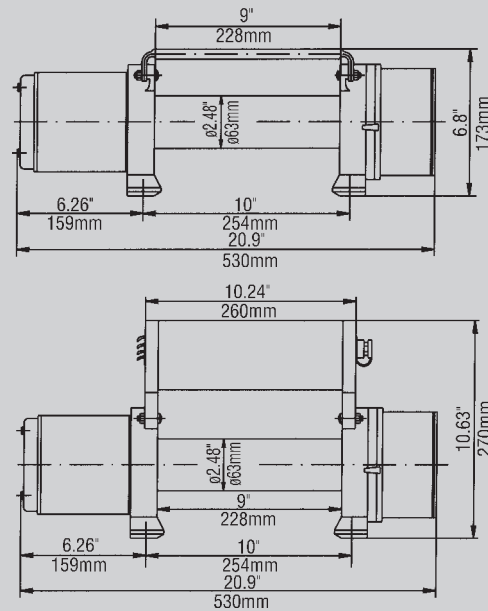
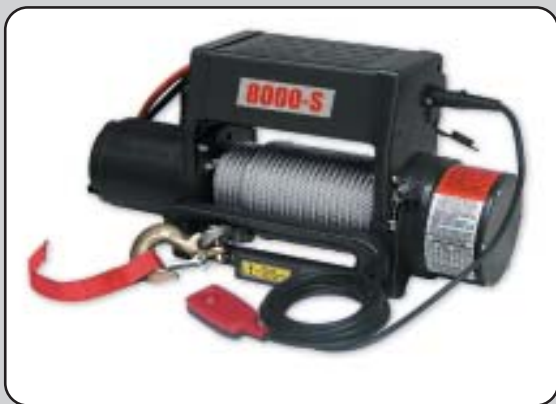

### Features:

- 1) Free spooling clutch
- 2) Automatic braking action
- 3) DC 12V or DC 24V power drive
- 4) Remote control with control box and switch
- 5) Wireless remote control

### Pull,Speed, Amperes, Volts(First layer)

| Line Pull<br>lbs (kgs) | Line Speed<br>ft/min (m/min) |           | Current<br>A |        |
|------------------------|------------------------------|-----------|--------------|--------|
|                        | 12V DC                       | 24V DC    | 12V DC       | 24V DC |
| 0                      | 13.0(3.9)                    | 17.8(5.4) | 40           | 30     |
| 2000(907)              | 9.8(3.0)                     | 13.8(4.2) | 110          | 60     |
| 4000(1814)             | 8.2(2.5)                     | 10.8(3.3) | 190          | 110    |
| 6000(2722)             | 6.0(1.8)                     | 7.9(2.4)  | 270          | 150    |
| 8000(3629)             | 4.3(1.3)                     | 5.6(1.7)  | 350          | 240    |

### Line Pull And Rope Capacity In Layer

| Layer | Rated Line Pull<br>lbs(kgs) | Total Rope On Drum<br>ft (m) |
|-------|-----------------------------|------------------------------|
| 1     | 8000(3622)                  | 19.6(6.0)                    |
| 2     | 6500(2948)                  | 42.6(13.0)                   |
| 3     | 5500(2495)                  | 68.9(21.0)                   |
| 4     | 4800(2177)                  | 95.0(29.0)                   |

### Fittings and Accessories(optional):



Website: [www.goldenwinch.es](http://www.goldenwinch.es)

# GOLDEN WINCH EW6000 SERIES

## GEW6000



### Specification:

|                                 |   |
|---------------------------------|---|
| Rated line pull                 | 6000lbs(2722kgs)  |
| Motor:Series wound              | 3.6kW/4.8hp(12V);4.2kW/5.6hp(24V)   |
| Gear reduction ratio            | 294:1(12V);210:1(24V)   |
| Cable(Dia. $\varnothing$ L)     | $\varnothing$ 9/32" $\varnothing$ 105" ( $\varnothing$ 7.2mm $\varnothing$ 32m) |
| Drum size(Dia. $\varnothing$ L) | $\varnothing$ 2.48" $\varnothing$ 9" ( $\varnothing$ 63mm $\varnothing$ 228mm)  |
| Mounting bolt pattern           | 10" $\varnothing$ 4.5" (254mm $\varnothing$ 114.3mm)                            |

### GEW6000:

|   |   |
|---|---|
| Overall dimensions(L $\varnothing$ W $\varnothing$ H) | 21.1" $\varnothing$ 7.1" $\varnothing$ 6.8" (536mm $\varnothing$ 180mm $\varnothing$ 173mm) |
| Weight  | 70.6lbs(32.0kgs)  |

### GEW6000-S:

|   |   |
|---|---|
| Overall dimensions(L $\varnothing$ W $\varnothing$ H) | 21.1" $\varnothing$ 7.1" $\varnothing$ 10.63" (536mm $\varnothing$ 180mm $\varnothing$ 270mm) |
| Weight  | 76lbs(34.5kgs)  |

## GEW6000-S

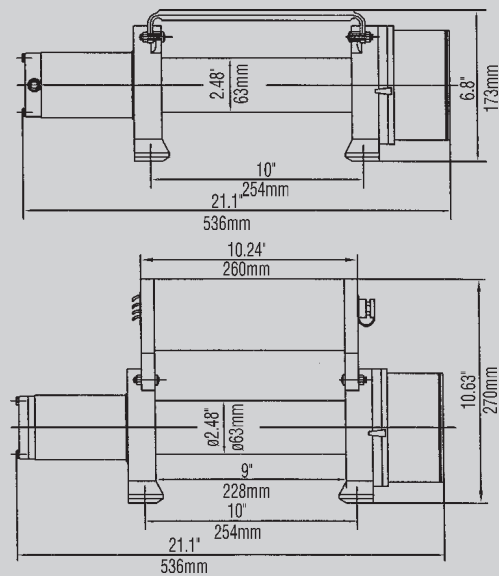

### Features:

- 1) Free spooling clutch
- 2) Automatic braking action
- 3) DC 12V or DC 24V power drive
- 4) Series wound motor
- 5) Remote control with control box and switch
- 6) Wireless remote control

### Pull,Speed, Amperes, Volts(First layer)

| Line Pull<br>lbs (kgs) | Line Speed<br>ft/min (m/min) |           | Current<br>A |        |
|------------------------|------------------------------|-----------|--------------|--------|
|                        | 12V DC                       | 24V DC    | 12V DC       | 24V DC |
| 0                      | 18.0(5.5)                    | 24.6(7.5) | 80           | 40     |
| 2000(907)              | 10.5(3.2)                    | 11.4(3.5) | 180          | 100    |
| 4000(1814)             | 8.2(2.5)                     | 9.5(2.9)  | 240          | 140    |
| 6000(2722)             | 5.9(1.8)                     | 8.2(2.5)  | 300          | 180    |

### Line Pull And Rope Capacity In Layer

| Layer | Rated Line Pull | Total Rope On Drum |
|-------|-----------------|--------------------|
|       | lbs(kgs)        | ft (m)             |
| 1     | 6000(2722)      | 21.3(6.5)          |
| 2     | 5000(2268)      | 47.5(14.5)         |
| 3     | 4200(1905)      | 77.0(23.5)         |
| 4     | 3700(1678)      | 105.0(32.0)        |

### Fittings and Accessories(optional):



# GOLDEN WINCH EW8000 SERIES

## GEW8000



## GEW8000-S



### Specification:

|                                 |  |
|---------------------------------|--|
| Rated line pull                 | 8000lbs(3629kgs)   |
| Motor:Series wound              | 3.6kW/4.8hp(12V); 4.8kW/6.4hp(24V)   |
| Gear reduction ratio            | 210:1(12V);150:1(24V)  |
| Cable(Dia. $\varnothing$ L)     | $\varnothing$ 5/16" $\varnothing$ 95' ( $\varnothing$ 8mm $\varnothing$ 29m)   |
| Drum size(Dia. $\varnothing$ L) | $\varnothing$ 2.48" $\varnothing$ 9" ( $\varnothing$ 63mm $\varnothing$ 228mm) |
| Mounting bolt pattern           | 10" $\varnothing$ 4.5" (254mm $\varnothing$ 114.3mm)                           |

### GEW8000:

|   |   |
|---|---|
| Overall dimensions(L $\varnothing$ W $\varnothing$ H) | 22.4" $\varnothing$ 7.1" $\varnothing$ 6.8" (570mm $\varnothing$ 180mm $\varnothing$ 173mm) |
| Weight  | 72.5lbs(32.88kgs)   |

### GEW8000-S:

|   |   |
|---|---|
| Overall dimensions(L $\varnothing$ W $\varnothing$ H) | 22.4" $\varnothing$ 7.1" $\varnothing$ 10.63" (570mm $\varnothing$ 180mm $\varnothing$ 270mm) |
| Weight  | 73.8lbs(33.48kgs)   |

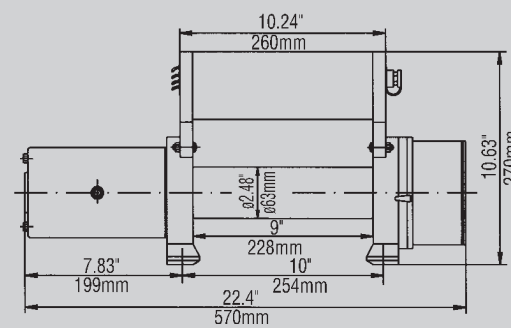
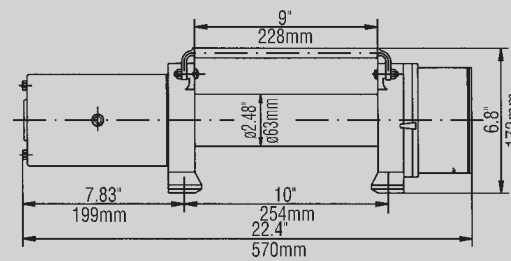

### Features:

- 1) Free spooling clutch
- 2) Automatic braking action
- 3) DC 12V or DC 24V power drive
- 4) Series wound motor
- 5) Remote control with control box and switch
- 6) Wireless remote control

### Pull, Speed, Amperes, Volts(First layer)

| Line Pull<br>lbs (kgs) | Line Speed<br>ft/min (m/min) |           | Current<br>A |        |
|------------------------|------------------------------|-----------|--------------|--------|
|                        | 12V DC                       | 24V DC    | 12V DC       | 24V DC |
| 0                      | 24(7.3)                      | 35(10.5)  | 80           | 50     |
| 2000(907)              | 13.0(3.8)                    | 19.0(5.8) | 150          | 90     |
| 4000(1814)             | 9.0(2.7)                     | 12.8(3.9) | 220          | 135    |
| 6000(2722)             | 7.0(2.1)                     | 10.0(3.0) | 270          | 170    |
| 8000(3629)             | 5.6(1.7)                     | 6.6(2.0)  | 320          | 210    |

### Line Pull And Rope Capacity In Layer

| Layer | Rated Line Pull<br>lbs(kgs) | Total Rope On Drum<br>ft (m) |
|-------|-----------------------------|------------------------------|
| 1     | 8000(3622)                  | 19.6(6.0)                    |
| 2     | 6500(2948)                  | 42.6(13.0)                   |
| 3     | 5500(2495)                  | 68.9(21.0)                   |
| 4     | 4800(2177)                  | 95.0(29.0)                   |

### Fittings and Accessories(optional):



Website: [www.goldenwinch.es](http://www.goldenwinch.es)

# GOLDEN WINCH EW9000 SERIES

## GEW9000



### Specification:

|                                 |  |
|---------------------------------|--|
| Rated line pull                 | 9000lbs(4082kgs)   |
| Motor:Series wound              | 3.6kW/4.8hp(12V); 4.8kW/6.4hp(24V)   |
| Gear reduction ratio            | 294:1(12V),210:1(24V)  |
| Cable(Dia. $\varnothing$ L)     | $\varnothing$ 21/64" $\varnothing$ 5' ( $\varnothing$ 8.3mm $\varnothing$ 29m) |
| Drum size(Dia. $\varnothing$ L) | $\varnothing$ 2.48" $\varnothing$ 9" ( $\varnothing$ 63mm $\varnothing$ 228mm) |
| Mounting bolt pattern           | 10" $\varnothing$ 4.5" (254mm $\varnothing$ 114.3mm)                           |

### GEW9000:

|   |   |
|---|---|
| Overall dimensions(L $\varnothing$ W $\varnothing$ H) | 22.4" $\varnothing$ 7.1" $\varnothing$ 6.8" (570mm $\varnothing$ 180mm $\varnothing$ 173mm) |
| Weight  | 73.8lbs(33.84kgs)   |

### GEW9000-S:

|   |   |
|---|---|
| Overall dimensions(L $\varnothing$ W $\varnothing$ H) | 22.4" $\varnothing$ 7.1" $\varnothing$ 10.63" (570mm $\varnothing$ 180mm $\varnothing$ 270mm) |
| Weight  | 75.3lbs(34.18kgs)   |

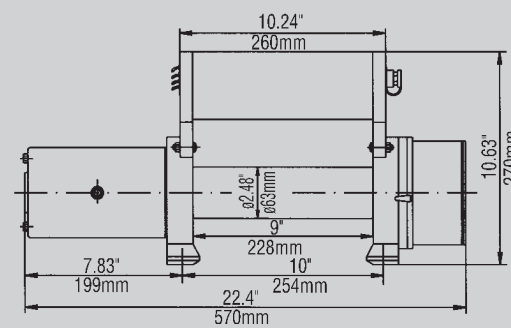
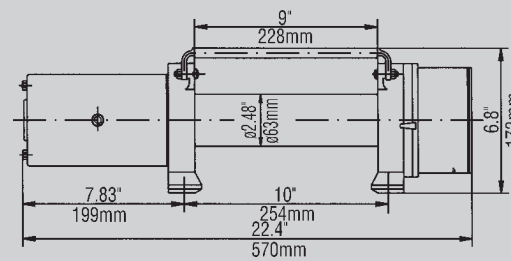

## GEW9000-S



### Features:

- 1) Free spooling clutch
- 2) Automatic braking action
- 3) DC 12V or DC 24V power drive
- 4) Series wound motor
- 5) Remote control with control box and switch
- 6) Wireless remote control

### Pull,Speed, Amperes, Volts(First layer)

| Line Pull<br>lbs (kgs) | Line Speed<br>ft/min (m/min) |           | Current<br>A |        |
|------------------------|------------------------------|-----------|--------------|--------|
|                        | 12V DC                       | 24V DC    | 12V DC       | 24V DC |
| 0                      | 17.0(5.2)                    | 23.0(7.0) | 80           | 50     |
| 2000(907)              | 11.0(3.3)                    | 15.0(4.5) | 120          | 75     |
| 4000(1814)             | 7.9(2.4)                     | 10.0(3.2) | 170          | 115    |
| 6000(2722)             | 6.2(1.9)                     | 8.0(2.5)  | 220          | 145    |
| 9000(4082)             | 5.0(1.5)                     | 6.6(2.0)  | 280          | 180    |

### Line Pull And Rope Capacity In Layer

| Layer | Rated Line Pull<br>lbs(kgs) | Total Rope On Drum<br>ft (m) |
|-------|-----------------------------|------------------------------|
| 1     | 9000(4082)                  | 19.6(6.0)                    |
| 2     | 7350(3334)                  | 42.6(13.0)                   |
| 3     | 6200(2812)                  | 68.9(21.0)                   |
| 4     | 5400(2449)                  | 95.0(29.0)                   |

### Fittings and Accessories(optional):



# GOLDEN WINCH EW10000 SERIES

## GEW10000



### Specification:

|                                 |  |
|---------------------------------|--|
| Rated line pull                 | 10000lbs(4536kgs)  |
| Motor:Series wound              | 4.2kW/5.5hp(12V); 5.5kW/7.5hp(24V)   |
| Gear reduction ratio            | 294:1(12V),210:1(24V)  |
| Cable(Dia. $\varnothing$ L)     | $\varnothing$ 3/8" $\varnothing$ 85' ( $\varnothing$ 9.2mm $\varnothing$ 26m)  |
| Drum size(Dia. $\varnothing$ L) | $\varnothing$ 2.48" $\varnothing$ 9" ( $\varnothing$ 63mm $\varnothing$ 228mm) |
| Mounting bolt pattern           | 10" $\varnothing$ 4.5" (254mm $\varnothing$ 114.3mm)                           |

### GEW10000:

|   |   |
|---|---|
| Overall dimensions(L $\varnothing$ W $\varnothing$ H) | 22.4" $\varnothing$ 7.1" $\varnothing$ 6.8" (570mm $\varnothing$ 180mm $\varnothing$ 173mm) |
| Weight  | 73.8lbs(33.48kgs)   |

### GEW10000-S:

|   |   |
|---|---|
| Overall dimensions(L $\varnothing$ W $\varnothing$ H) | 22.4" $\varnothing$ 7.1" $\varnothing$ 10.63" (570mm $\varnothing$ 180mm $\varnothing$ 270mm) |
| Weight  | 75.1lbs(34.08kgs)   |

## GEW10000-S

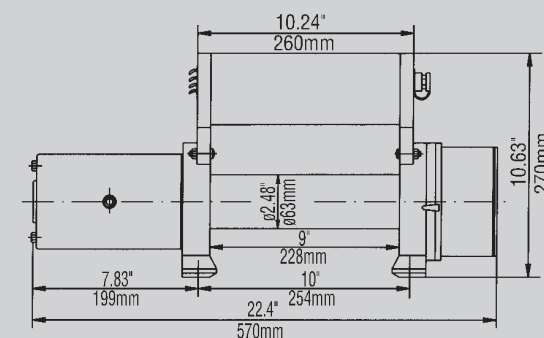
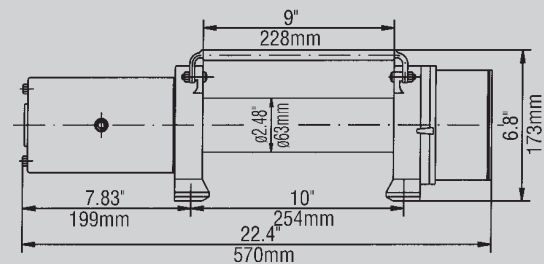

### Features:

- 1) Free spooling clutch
- 2) Automatic braking action
- 3) DC 12V or DC 24V power drive
- 4) Series wound motor
- 5) Remote control with control box and switch
- 6) Wireless remote control

### Pull,Speed, Amperes, Volts(First layer)

| Line Pull   | Line Speed |         | Current |        |
|-------------|------------|---------|---------|--------|
|             | ft/min     | m/min   | 12V DC  | 24V DC |
| lbs (kgs)   | 12V DC     | 24V DC  | 12V DC  | 24V DC |
| 0           | 17.0(5.2)  | 23(7.0) | 80      | 50     |
| 4000(1814)  | 7.9(2.4)   | 10(3.2) | 170     | 115    |
| 6000(2722)  | 6.2(1.9)   | 8(2.5)  | 210     | 145    |
| 8000(3629)  | 5.6(1.7)   | 7(2.1)  | 250     | 170    |
| 10000(4536) | 4.6(1.4)   | 6(1.8)  | 300     | 200    |

### Line Pull And Rope Capacity In Layer

| Layer | Line Pull And Rope Capacity In Layer |                    |
|-------|--------------------------------------|--------------------|
|       | Rated Line Pull                      | Total Rope On Drum |
|       | lbs(kgs)                             | ft (m)             |
| 1     | 10000(4536)                          | 18.0(5.5)          |
| 2     | 8000(3629)                           | 39.4(12)           |
| 3     | 6600(2994)                           | 64(19.5)           |
| 4     | 5600(2540)                           | 85(26.0)           |

### Fittings and Accessories(optional):



Website: [www.goldenwinch.es](http://www.goldenwinch.es)

# GOLDEN WINCH EW9500 SERIES

## EWX9500



### Specification:

|                                 |  |
|---------------------------------|--|
| Rated line pull                 | 9500lbs(4309kgs)   |
| Motor:Series wound              | 4.2kW/5.5hp(12V); 5.5kW/7.5hp(24V)   |
| Gear reduction ratio            | 233:1(12V,24V)   |
| Cable(Dia. $\varnothing$ L)     | $\varnothing$ 3/8" $\varnothing$ 85' ( $\varnothing$ 9.2mm $\varnothing$ 26m)  |
| Drum size(Dia. $\varnothing$ L) | $\varnothing$ 2.48" $\varnothing$ 9" ( $\varnothing$ 63mm $\varnothing$ 228mm) |
| Mounting bolt pattern           | 10" $\varnothing$ 4.5" (254mm $\varnothing$ 114.3mm)                           |

### EWX9500:

|   |   |
|---|---|
| Overall dimensions(L $\varnothing$ W $\varnothing$ H) | 21.46" $\varnothing$ 6.30" $\varnothing$ 9.00" (545mm $\varnothing$ 60mm $\varnothing$ 220mm) |
| Weight  | 68.3lbs(31kgs)  |

### EWX9500-S:

|   |   |
|---|---|
| Overall dimensions(L $\varnothing$ W $\varnothing$ H) | 21.46" $\varnothing$ 6.30" $\varnothing$ 9.27" (545mm $\varnothing$ 60mm $\varnothing$ 247mm) |
| Weight  | 69.2lbs(31.38kgs)   |

### Features:

- 1) Free spooling clutch
- 2) Automatic braking action
- 3) DC 12V or DC 24V power drive
- 4) Series wound motor
- 5) Full steel reducer gear
- 6) Adopt four plant gears in output stage of gear reducer very strong for heavy load
- 7) Remote control with control box and switch
- 8) Wireless remote control
- 9) SWR tensioner available

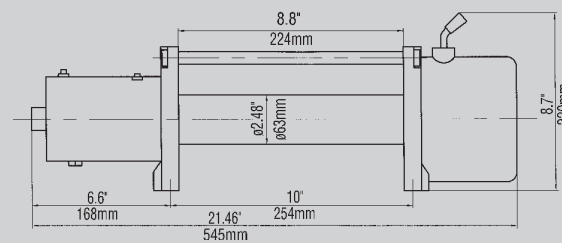

### Pull, Speed, Amperes, Volts(First layer)

| Line Pull<br>lbs (kgs) | Line Speed<br>ft/min (m/min) |            | Current<br>A |        |
|------------------------|------------------------------|------------|--------------|--------|
|                        | 12V DC                       | 24V DC     | 12V DC       | 24V DC |
| 0                      | 22.05(6.8)                   | 24.28(7.4) | 65           | 40     |
| 2000(907)              | 11.67(3.6)                   | 19.69(6.0) | 179          | 140    |
| 3000(1361)             | 10.05(3.1)                   | 12.8(3.9)  | 203          | 153    |
| 6000(2722)             | 9.08(2.8)                    | 11.15(3.4) | 286          | 220    |
| 8000(3629)             | 7.13(2.2)                    | 8.53(2.6)  | 330          | 245    |
| 9500(4309)             | 6.16(1.9)                    | 7.87(2.4)  | 365          | 260    |

### Line Pull And Rope Capacity In Layer

| Layer | Rated Line Pull<br>lbs(kgs) | Total Rope On Drum<br>ft (m) |
|-------|-----------------------------|------------------------------|
| 1     | 9500(4309)                  | 18(5.5)                      |
| 2     | 7600(3447)                  | 39.4(12)                     |
| 3     | 6200(2812)                  | 64(19.5)                     |
| 4     | 5400(2449)                  | 85(26.0)                     |

### Fittings and Accessories(optional):



# GOLDEN WINCH EW10000/12000 SERIES

**NEW10000**



**NEW12000**



**Specification:**

| Item  | NEW10000   | NEW12000   |
|---|--|--|
| Rated line pull                                       | 10000lbs(4536kgs)  | 12000lbs(5443kgs)  |
| Motor:Series wound                                    | 3.6kW/4.8hp(12V); 4.8kW/6.4hp(24V)   | 4.2kW/5.5hp(12V); 5.5kW/7.5hp(24V)   |
| Gear reduction ratio                                  | 402:1  | 402:1  |
| Cable(Dia. $\varnothing$ L)                           | $\varnothing$ 3/8" $\varnothing$ 92' ( $\varnothing$ 9.2mm $\varnothing$ 28m)              | $\varnothing$ 13/32" $\varnothing$ 87' ( $\varnothing$ 10.2mm $\varnothing$ 26.5m)         |
| Drum size(Dia. $\varnothing$ L)                       | $\varnothing$ 2.8" $\varnothing$ 8.8" ( $\varnothing$ 72mm $\varnothing$ 222mm)            | $\varnothing$ 2.8" $\varnothing$ 8.8" ( $\varnothing$ 72mm $\varnothing$ 222mm)            |
| Mounting bolt pattern                                 | 10" $\varnothing$ 4.5" (254mm $\varnothing$ 114.3mm)                                       | 10" $\varnothing$ 4.5" (254mm $\varnothing$ 114.3mm)                                       |
| Overall dimensions(L $\varnothing$ W $\varnothing$ H) | 22.4" $\varnothing$ 8.1" $\varnothing$ 11" (571mm $\varnothing$ 206mm $\varnothing$ 280mm) | 22.8" $\varnothing$ 8.1" $\varnothing$ 11" (579mm $\varnothing$ 206mm $\varnothing$ 280mm) |
| Weight  | 128.5lbs(58.28kgs)   | 132.3lbs(61kgs)  |

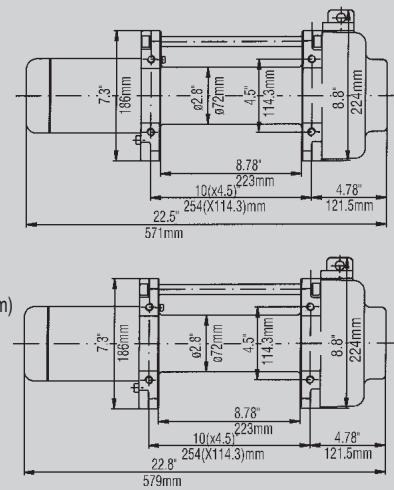

**Pull,Speed, Amperes, Volts(First layer)**

| Line Pull   | Line Speed     |          | Current |        |
|-------------|----------------|----------|---------|--------|
|             | ft/min (m/min) |          | A       |        |
| lbs (kgs)   | 12V DC         | 24V DC   | 12V DC  | 24V DC |
| 0           | 14.0(4.2)      | 16.0(5)  | 65      | 40     |
| 3000(1361)  | 9.0(2.8)       | 10.0(3)  | 123     | 100    |
| 6000(2722)  | 6.6(2)         | 7.5(2.3) | 220     | 118    |
| 8000(3629)  | 6.0(1.7)       | 6.6(2)   | 255     | 150    |
| 10000(4536) | 5.0(1.6)       | 6.0(1.8) | 300     | 190    |

**Line Pull And Rope Capacity In Layer**

| Layer | Rated Line Pull | Total Rope On Drum |
|-------|-----------------|--------------------|
|       |                 |                    |
| 1     | 10000(4536)     | 18(5.6)            |
| 2     | 8000(3629)      | 41(12.6)           |
| 3     | 6700(3039)      | 66(20)             |
| 4     | 5747(2607)      | 92(28)             |

**Pull,Speed, Amperes, Volts(First layer)**

| Line Pull   | Line Speed     |           | Current |        |
|-------------|----------------|-----------|---------|--------|
|             | ft/min (m/min) |           | A       |        |
| lbs (kgs)   | 12V DC         | 24V DC    | 12V DC  | 24V DC |
| 0           | 15.7(4.8)      | 16.4(5.0) | 50      | 40     |
| 6000(2722)  | 10.1(3.1)      | 11.1(3.4) | 130     | 100    |
| 8000(3629)  | 8.5(2.6)       | 9.2(2.8)  | 210     | 120    |
| 10000(4536) | 6.6(2.0)       | 7.2(2.2)  | 250     | 145    |
| 12000(5443) | 5.9(1.8)       | 6.2(1.9)  | 310     | 185    |

**Line Pull And Rope Capacity In Layer**

| Layer | Rated Line Pull | Total Rope On Drum |
|-------|-----------------|--------------------|
|       |                 |                    |
| 1     | 12000(5443)     | 18(5.6)            |
| 2     | 9800(4445)      | 41(12.5)           |
| 3     | 8300(3765)      | 66(20)             |
| 4     | 7200(3266)      | 87(26.5)           |

**Features:**

- 1) Free spooling clutch
- 2) Automatic braking action
- 3) Great gear ratio designed for steering power drive
- 4) Specially designed differential gearing for heavy duty
- 5) Specially designed shape for convenient installation and good looking
- 6) Remote control with control box and switch
- 7) Wireless remote control
- 8) DC 12V or DC 24V power drive
- 9) SWR tensioner available
- 10) Can be for engineering use

**Fittings and Accessories(optional):**



Website: [www.goldenwinch.es](http://www.goldenwinch.es)

# EW15000 SERIES GOLDEN WINCH EW12000 TWO SPEED

## NEW15000



### Specification:

|   |   |
|---|---|
| Rated line pull                                       | 15000lbs(6804kgs)   |
| Motor:Series wound                                    | 4.2kW/5.5hp(12V); 5.5kW/7.5hp(24V)  |
| Gear reduction ratio                                  | 450:1   |
| Cable(Dia. $\varnothing$ )                            | $\varnothing$ 7/16" $\varnothing$ 92' ( $\varnothing$ 11mm $\varnothing$ 28m)                 |
| Drum size(Dia. $\varnothing$ )                        | $\varnothing$ 3.5" $\varnothing$ 8.8" ( $\varnothing$ 89mm $\varnothing$ 222mm)               |
| Mounting bolt pattern                                 | 10" $\varnothing$ 4.5" (254mm $\varnothing$ 114.3mm)  |
| Overall dimensions(L $\varnothing$ W $\varnothing$ H) | 23.07" $\varnothing$ 8.9" $\varnothing$ 9.57" (586mm $\varnothing$ 225mm $\varnothing$ 243mm) |
| Weight  | 162.9lbs(73.88kgs)  |

### Pull,Speed, Amperes, Volts(First layer)

| Line Pull<br>lbs (kgs) | Line Speed<br>ft/min (m/min) |           | Current<br>A |        |
|------------------------|------------------------------|-----------|--------------|--------|
|                        | 12V DC                       | 24V DC    | 12V DC       | 24V DC |
| 0                      | 15(4.6)                      | 16.0(4.8) | 60           | 40     |
| 8000(3629)             | 8.2(2.5)                     | 8.5(2.7)  | 220          | 123    |
| 10000(4536)            | 6.0(1.9)                     | 6.8(2.1)  | 260          | 145    |
| 12000(5443)            | 5.6(1.7)                     | 6.0(1.8)  | 300          | 170    |
| 15000(6804)            | 4.3(1.3)                     | 5.0(1.5)  | 330          | 210    |

### Line Pull And Rope Capacity In Layer

| Layer | Rated Line Pull | Total Rope On Drum |
|-------|-----------------|--------------------|
|       | lbs(kgs)        | ft (m)             |
| 1     | 15000(6804)     | 19(6.0)            |
| 2     | 12000(5443)     | 42(13.0)           |
| 3     | 10100(4581)     | 68(21.0)           |
| 4     | 8720(3955)      | 92(28.0)           |

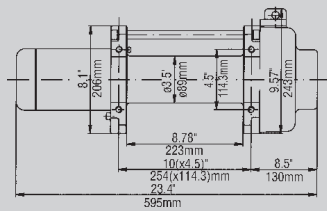

## BEW12000



**TWO SPEED WINCHES**

### Specification:

|   |  |
|---|--|
| Rated line pull                                       | 12000lbs(5443kgs)  |
| Motor:Series wound                                    | 4.2kW/5.5hp(12V); 5.5kW/7.5hp(24V)   |
| Gear reduction ratio                                  | 450:1; 75:1  |
| Cable(Dia. $\varnothing$ )                            | $\varnothing$ 7/16" $\varnothing$ 108' ( $\varnothing$ 11mm $\varnothing$ 33m)             |
| Drum size(Dia. $\varnothing$ )                        | $\varnothing$ 4.61" $\varnothing$ 8.8" ( $\varnothing$ 113mm $\varnothing$ 222mm)          |
| Mounting bolt pattern                                 | 10" $\varnothing$ 4.5" (254mm $\varnothing$ 114.3mm)                                       |
| Overall dimensions(L $\varnothing$ W $\varnothing$ H) | 24" $\varnothing$ 8.9" $\varnothing$ 9.57" (608mm $\varnothing$ 225mm $\varnothing$ 243mm) |
| Weight  | 172.6lbs(78.28kgs)   |

### Pull,Speed, Amperes, Volts(First layer)

| Line Pull<br>lbs (kgs) | Line Speed<br>ft/min (m/min) |           | Current<br>A |        |
|------------------------|------------------------------|-----------|--------------|--------|
|                        | 12V DC                       | 24V DC    | 12V DC       | 24V DC |
| 0                      | 17.7(5.4)                    | 19.7(6.0) | 60           | 40     |
| 8000(3629)             | 10.0(3.0)                    | 10.6(3.2) | 260          | 145    |
| 10000(4536)            | 7.5(2.3)                     | 8.3(2.5)  | 300          | 170    |
| 12000(5443)            | 5.4(1.65)                    | 6.0(1.8)  | 330          | 210    |

### Line Pull And Rope Capacity In Layer

| Layer | Rated Line Pull | Total Rope On Drum |
|-------|-----------------|--------------------|
|       | lbs(kgs)        | ft (m)             |
| 1     | 12000(5443)     | 25.6(8.2)          |
| 2     | 10200(4627)     | 54(17.3)           |
| 3     | 8860(4019)      | 85(27.0)           |
| 4     | 8000(3629)      | 108(33.0)          |

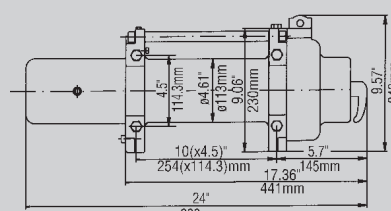

### Features:

- 1) Free spooling clutch
- 2) Automatic braking action
- 3) Series wound motor
- 4) Specially designed differential gearing for heavy duty
- 5) Specially designed shape for convenient installation and good looking
- 6) Remote control with control box and switch
- 7) Wireless remote control
- 8) DC 12V or DC 24V power drive
- 9) SWR tensioner available

### Features:

- 1) Free spooling clutch
- 2) Automatic braking action
- 3) Series wound motor
- 4) Specially designed differential gearing for heavy duty
- 5) Specially designed shape for convenient installation and good looking
- 6) Remote control with control box and switch
- 7) Wireless remote control
- 8) Fast enwind and fast winching
- 9) Bigger winch drum for longer life of wire rope
- 10) DC 12V or DC 24V power drive
- 11) SWR tensioner available

### Fittings and Accessories(optional):



# GOLDEN WINCH HW10000/12000 SERIES HYDRAULIC

**NHW10000**



**NHW12000**



**Specification:**

| Item  | NHW10000  | NHW12000  |
|---|---|---|
| Rated line pull                                       | 10000lbs(4536kgs)   | 12000lbs(5443kgs)   |
| Motor displacement                                    | 50ml/r  | 80ml/r  |
| Oil flow  | 5.3-13.2G/min (20-50 L/min)   | 5.3-15.9G/min (20-60 L/min)   |
| Pressure  | 14 MPa  | 10 MPa  |
| Gear reduction ratio                                  | 33:1  | 33:1  |
| Cable(Dia. $\varnothing$ L)                           | $\varnothing$ 13/32" $\varnothing$ 87' ( $\varnothing$ 10.2mm $\varnothing$ 26.5m)        | $\varnothing$ 7/16" $\varnothing$ 92' ( $\varnothing$ 11mm $\varnothing$ 28m)               |
| Drum size(Dia. $\varnothing$ L)                       | $\varnothing$ 2.8" $\varnothing$ 8.8" ( $\varnothing$ 72mm $\varnothing$ 222mm)           | $\varnothing$ 3.5" $\varnothing$ 8.8" ( $\varnothing$ 89mm $\varnothing$ 222mm)             |
| Overall dimensions(L $\varnothing$ W $\varnothing$ H) | 20" $\varnothing$ 8.1" $\varnothing$ 8.8" (510mm $\varnothing$ 206mm $\varnothing$ 224mm) | 20.9" $\varnothing$ 8.1" $\varnothing$ 8.8" (515mm $\varnothing$ 206mm $\varnothing$ 224mm) |
| Mounting bolt pattern                                 | 10" $\varnothing$ 4.5" (254mm $\varnothing$ 114.3mm)                                      | 10" $\varnothing$ 4.5" (254mm $\varnothing$ 114.3mm)  |
| Weight  | 135.1lbs(61.28kgs)  | 146.1lbs(66.28kgs)  |

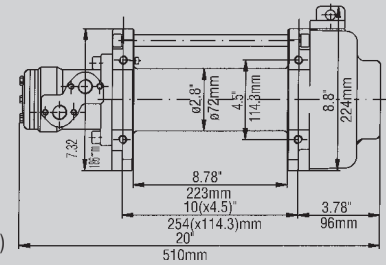

**Line Pull, Pressure; Flow, Speed (First layer)**

| Line pull lbs (kgs) | Pressure (MPa) | Flow G/min(L/min) | Line speed ft/min(m/min) | Line pull lbs (kgs) | Pressure (MPa) | Flow G/min(L/min) | Line speed ft/min(m/min) |
|---------------------|----------------|-------------------|--------------------------|---------------------|----------------|-------------------|--------------------------|
| 0                   | 1.0            | 5.3(20)           | 10.0(2.8)                | 0                   | 1.0            | 5.3(20)           | 7.2(2.2)                 |
| 6000(2722)          | 8.5            | 7.9(30)           | 15.0(4.6)                | 8000(3629)          | 6.0            | 7.9(30)           | 11.0(3.4)                |
| 10000(4536)         | 13.0           | 13.2(50)          | 26.0(7.6)                | 10000(4536)         | 8.0            | 13.2(50)          | 18.0(5.6)                |
|                     |                |                   |                          | 12000(5443)         | 10.0           | 15.9(60)          | 22.0(6.8)                |

**Line Pull And Rope Capacity In Layer**

| Layer | Rated Line Pull lbs(kgs) | Total Rope On Drum ft (m) | Layer | Rated Line Pull lbs(kgs) | Total Rope On Drum ft (m) |
|-------|--------------------------|---------------------------|-------|--------------------------|---------------------------|
| 1     | 10000(4536)              | 18(5.6)                   | 1     | 12000(5443)              | 19(6)                     |
| 2     | 8020(3638)               | 41(12.5)                  | 2     | 9800(4445)               | 42(13)                    |
| 3     | 6700(3039)               | 66(20.0)                  | 3     | 8300(3765)               | 68(21)                    |
| 4     | 5800(2631)               | 87(26.5)                  | 4     | 7200(3266)               | 92(28)                    |

**Features:**

- 1) Free spooling clutch
- 2) Automatic braking action
- 3) Great gear ratio designed for steering power drive
- 4) Specially designed differential gearing for heavy duty
- 5) Specially designed shape for convenient installation and good looking
- 6) Remote control with control box and switch
- 7) Wireless remote control
- 8) 12V/24V DC electric valve control
- 9) SWR tensioner available
- 10) Can be for engineering use

**Fittings and Accessories(optional):**



Website: [www.goldenwinch.es](http://www.goldenwinch.es)

# GOLDEN WINCH

## HW15000 SERIES HYDRAULIC

## HW10000 SERIES TWO SPEED HYDRAULIC WINCHES

### NHW15000



#### Specification:

|   |   |
|---|---|
| Item  | NHW15000  |
| Rated line pull                                       | 15000lbs(6804kgs)   |
| Motor displacement                                    | 80ml/r  |
| Oil flow  | 5.3-15.9G/min (20-60 L/min)   |
| Pressure  | 14 MPa  |
| Gear reduction ratio                                  | 37:1  |
| Cable(Dia. $\varnothing$ L)                           | $\varnothing$ 15/32" $\varnothing$ 87" ( $\varnothing$ 12mm $\varnothing$ 26.5m)            |
| Drum size(Dia. $\varnothing$ L)                       | $\varnothing$ 3.5" $\varnothing$ 8.8" ( $\varnothing$ 89mm $\varnothing$ 222mm)             |
| Overall dimensions(L $\varnothing$ W $\varnothing$ H) | 20.9" $\varnothing$ 8.9" $\varnothing$ 9.7" (530mm $\varnothing$ 225mm $\varnothing$ 247mm) |
| Mounting bolt pattern                                 | 14" $\varnothing$ 4.5" (254mm $\varnothing$ 114.3mm)  |
| Weight  | 151.9lbs(68.88kgs)  |

#### Line Pull, Pressure; Flow, Speed (First layer)

| Line pull lbs (kgs) | Pressure (MPa) | Flow G/min(L/min) | Line speed ft/min(m/min) |
|---------------------|----------------|-------------------|--------------------------|
| 0                   | 1.0            | 5.3(20)           | 7.2(2.2)                 |
| 8000(3629)          | 6.0            | 7.9(30)           | 11.0(3.4)                |
| 12000(5443)         | 9.5            | 13.2(50)          | 18.0(5.6)                |
| 15000(6804)         | 13.0           | 15.9(60)          | 22.0(6.8)                |

#### Line Pull And Rope Capacity In Layer

| Layer | Rated Line Pull lbs(kgs) | Total Rope On Drum ft (m) |
|-------|--------------------------|---------------------------|
| 1     | 15000(6804)              | 18.7(5.7)                 |
| 2     | 12000(5443)              | 41.0(12.5)                |
| 3     | 10000(4536)              | 65.6(20.0)                |
| 4     | 8720(3955)               | 87.0(26.5)                |

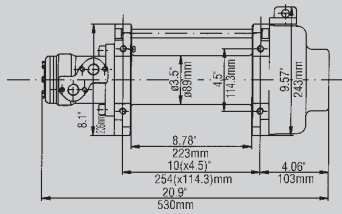

### BHW10000



#### Specification:

|   |   |
|---|---|
| Item  | BHW10000  |
| Rated line pull                                       | 10000lbs(4536kgs)   |
| Motor displacement                                    | 80ml/r  |
| Oil flow  | 5.3-13.2G/min (20-50 L/min)   |
| Pressure  | 8.5 MPa   |
| Gear reduction ratio                                  | 33:1 1:1  |
| Cable(Dia. $\varnothing$ L)                           | $\varnothing$ 13/32" $\varnothing$ 87" ( $\varnothing$ 10.2mm $\varnothing$ 26.5m)            |
| Drum size(Dia. $\varnothing$ L)                       | $\varnothing$ 2.8" $\varnothing$ 8.8" ( $\varnothing$ 72mm $\varnothing$ 222mm)               |
| Overall dimensions(L $\varnothing$ W $\varnothing$ H) | 21.9" $\varnothing$ 7.32" $\varnothing$ 8.8" (570mm $\varnothing$ 206 mm $\varnothing$ 224mm) |
| Mounting bolt pattern                                 | 10" $\varnothing$ 4.5" (254mm $\varnothing$ 114.3mm)  |
| Weight  | 144.0lbs(65.28kgs)  |

#### Line Pull, Pressure; Flow, Speed (First layer)

| Line pull lbs (kgs) | Pressure (MPa) | Flow G/min(L/min) | Line speed ft/min(m/min) | High speed m/min |
|---------------------|----------------|-------------------|--------------------------|------------------|
| 0                   | 1              | 5.3(20)           | 6.6(2.0)                 | 0-50             |
| 6000(2722)          | 6.0            | 7.9(30)           | 9.2(2.8)                 | /                |
| 10000(4536)         | 8.5            | 13.2(50)          | 15.2(4.6)                | /                |
|                     |                | 15.9(60)          | 18.4(5.6)                | /                |

#### Line Pull And Rope Capacity In Layer

| Layer | Rated Line Pull lbs(kgs) | Total Rope On Drum ft (m) |
|-------|--------------------------|---------------------------|
| 1     | 10000(4536)              | 18(5.6)                   |
| 2     | 8020(3638)               | 41(12.5)                  |
| 3     | 6700(3039)               | 66(20.0)                  |
| 4     | 5800(2631)               | 87(26.5)                  |

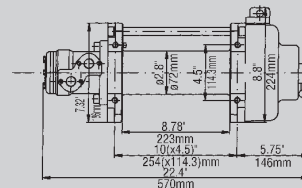

#### Features:

- 1) Free spooling clutch
- 2) Automatic braking action
- 3) Great gear ratio designed for steering power drive
- 4) Specially designed differential gearing for heavy duty
- 5) Specially designed shape for convenient installation and good looking
- 6) Remote control with control box and switch
- 7) Wireless remote control
- 8) 12V/24V DC electric valve control
- 9) SWR tensioner available
- 10) Can be for engineering use

#### Features:

- 1) Free spooling clutch
- 2) Automatic braking action
- 3) Great gear ratio designed for steering power drive
- 4) Specially designed differential gearing for heavy duty
- 5) Specially designed shape for convenient installation and good looking
- 6) Remote control with control box and switch
- 7) Wireless remote control
- 8) Fast unwind and fast winching
- 9) Bigger winch drum for longer life of wire rope
- 10) 12V/24V DC electric valve control
- 11) SWR tensioner available

#### Fittings and Accessories(optional):



# GOLDEN WINCH

# HW12000/15000 SERIES TWO SPEED HYDRAULIC WINCHES

**BHW12000**



**BHW15000**



**Specification:**

| Item  | BHW12000   | BHW15000   |
|---|--|--|
| Rated line pull                                       | 12000lbs(5443kgs)  | 15000lbs(6804kgs)  |
| Motor displacement                                    | 80ml/r   | 80ml/r   |
| Oil flow  | 5.3~15.9G/min (20~60 L/min)  | 5.3~15.9G/min (20~60 L/min)  |
| Pressure  | 10 MPa   | 14MPa  |
| Gear reduction ratio                                  | 33:1 1:1   | 37:1 1:1   |
| Cable(Dia. $\varnothing$ L)                           | $\varnothing$ 7/16" $\varnothing$ 92' ( $\varnothing$ 11mm $\varnothing$ 28m)                | $\varnothing$ 15/32" $\varnothing$ 87' ( $\varnothing$ 12mm $\varnothing$ 26.5m)             |
| Drum size(Dia. $\varnothing$ L)                       | $\varnothing$ 3.5" $\varnothing$ 8.8" ( $\varnothing$ 89mm $\varnothing$ 222mm)              | $\varnothing$ 3.5" $\varnothing$ 8.8" ( $\varnothing$ 89mm $\varnothing$ 222mm)              |
| Overall dimensions(L $\varnothing$ W $\varnothing$ H) | 22.6" $\varnothing$ 8.1" $\varnothing$ 9.57" (570mm $\varnothing$ 206mm $\varnothing$ 224mm) | 22.6" $\varnothing$ 8.9" $\varnothing$ 9.57" (575mm $\varnothing$ 225mm $\varnothing$ 243mm) |
| Mounting bolt pattern                                 | 10" $\varnothing$ 4.5" (254mm $\varnothing$ 114.3mm)   | 10" $\varnothing$ 4.5" (254mm $\varnothing$ 114.3mm)   |
| Weight  | 144lbs(65.28kgs)   | 167lbs(75.78kgs)   |

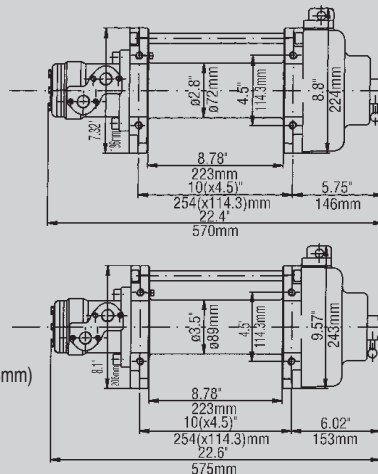

**Line Pull, Pressure; Flow, Speed (First layer)**

| Line pull<br>lbs (kgs) | Pressure<br>MPa | Flow<br>G/min(L/min) | Line speed<br>ft/min(m/min) | High speed<br>m/min | Line pull<br>lbs (kgs) | Pressure<br>MPa | Flow<br>G/min(L/min) | Line speed<br>ft/min(m/min) | High speed<br>m/min |
|------------------------|-----------------|----------------------|-----------------------------|---------------------|------------------------|-----------------|----------------------|-----------------------------|---------------------|
| 0                      | 1               | 5.3(20)              | 3.6(1.1)                    | 0-50                | 0                      | 1.0             | 5.3(20)              | 3.6(1.1)                    | 0-60                |
| 6000(2722)             | 6.0             | 7.9(30)              | 5.5(1.7)                    | /                   | 8000(3629)             | 6.0             | 7.9(30)              | 5.5(1.7)                    | /                   |
| 10000(4536)            | 8.0             | 13.2(50)             | 9.2(2.8)                    | /                   | 12000(5443)            | 9.5             | 13.2(50)             | 9.2(2.8)                    | /                   |
| 12000(5443)            | 10.0            | 15.9(60)             | 11.0(3.4)                   | /                   | 15000(6804)            | 13              | 15.9(60)             | 11.0(3.4)                   | /                   |

**Line Pull And Rope Capacity In Layer**

| Layer | Rated Line Pull<br>lbs(kgs) | Total Rope On Drum<br>ft (m) | Layer | Rated Line Pull<br>lbs(kgs) | Total Rope On Drum<br>ft (m) |
|-------|-----------------------------|------------------------------|-------|-----------------------------|------------------------------|
| 1     | 12000(5443)                 | 19(6)                        | 1     | 15000(6804)                 | 18.7(5.7)                    |
| 2     | 9800(4445)                  | 42(13)                       | 2     | 12000(5443)                 | 41.0(12.5)                   |
| 3     | 8300(3765)                  | 68(21)                       | 3     | 10000(4536)                 | 65.6(20.0)                   |
| 4     | 7200(3266)                  | 92(28)                       | 4     | 8720(3955)                  | 87.0(26.5)                   |

**Features:**

- 1) Free spooling clutch
- 2) Automatic braking action
- 3) Great gear ratio designed for steering power drive
- 4) Specially designed differential gearing for heavy duty
- 5) Specially designed shape for convenient installation and good looking
- 6) 12V/24V DC electric valve control
- 7) Wire remote control
- 8) Wireless remote control
- 9) SWR tensioner available
- 10) Fast enwind and fast winching
- 11) Can be for engineering use

**Fittings and Accessories(optional):**



Website: [www.goldenwinch.es](http://www.goldenwinch.es)

# **GOLDEN WINCH** ACCESSORIES

## Hand Winch

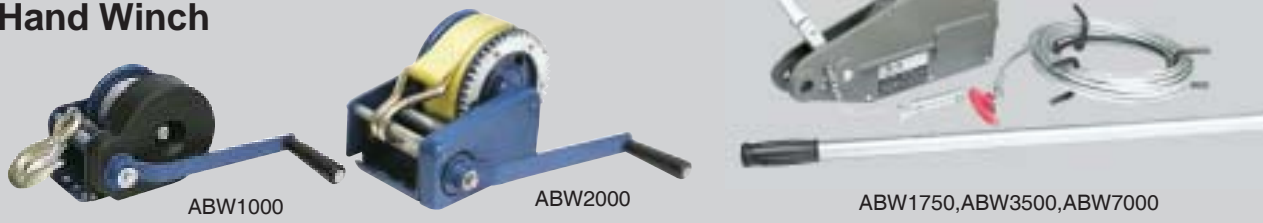

## Hand Puller (1T,2T,3T,4T)



## Ratchet Strap



## Wheel Chock



## NS-A050



## High Lift Jack

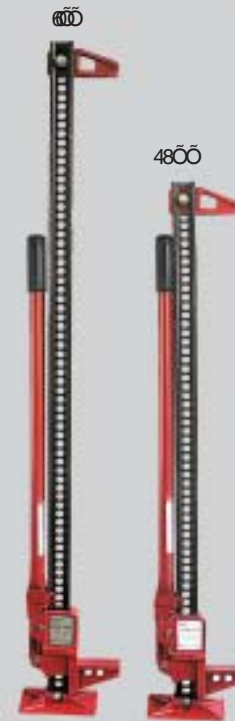

## Parking Saver

# GOLDEN WINCH

# ACCESSORIES

**Kew 2000-P**



**Gloves**



**Tow Strap**



**Quick Connector**

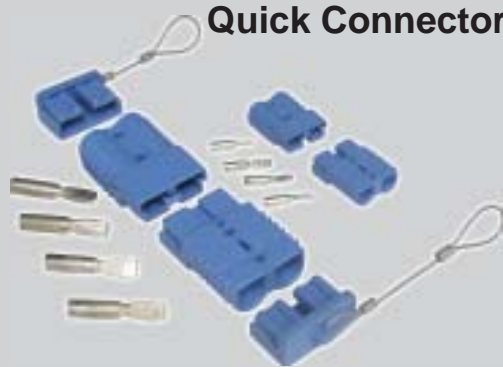

**Bow Shackle**



**D-Shackle**



**Receiver Shackle Bracket**



**Tree Trunk Savers**



**Accessory Kits**



# **GOLDEN WINCH**

## **POWER EQUIPMENT**

IMPORTADO POR CARMEN JULIA 123 S.L • N.I.F B-12714838 OROPESA DEL MAR.

### **SALES DEPARTMENT**

ADD: 10F (EAST) WORLD TRADE BUILDING  
SHUANGXI WEST ROAD, JINHUA,  
ZHEJIANG, CHINA

TEL: +86-579-2371528 2376218 2398382 2378444

FAX: +86-579-2387931

P.C.: 321000

**HOTLINE: +86-579-2371528**

WEBSITE: [runva.en.alibaba.com](http://runva.en.alibaba.com)  
[www.goldenwinch.com](http://www.goldenwinch.com)  
[www.jhrh.net](http://www.jhrh.net)

### **RUNVA SPAIN-PORTUGAL**

CARMEN JULIA 123 SL  
E-12594 OROPESA DEL MAR, CASTELLON  
TEL/FAX 0034 964313555 MOVIL 656269029 (JAN)  
E-MAIL: [carmenjulia123@hotmail.com](mailto:carmenjulia123@hotmail.com)

### **DISTRIMAXEL - COLOMBIA**

CALI- VALLE  
TEL/FAX 337 2668  
MOVIL 316 5353368/316 2892282  
MARTHA-MELISSA  
E-MAIL: [distrimaxel@hotmail.com](mailto:distrimaxel@hotmail.com)